





## 21 Mansfield Way KELLYVILLE NSW

Proudly positioned on the high side of a quiet street that edges Cameo Place Reserve, this flawless dual level residence offers light-filled and easy-care contemporary living just a short stroll to Sherwood Ridge Public School, William Clarke College, city bus and Plaza. Showcasing open plan interiors and a sun-drenched north to rear orientation, the home features lounge and dining, a study, fully equipped U-shaped gas kitchen and a family room opening out to alfresco entertaining. The upper level consists of four double bedrooms with the master including an ensuite, walk-in robe and Juliet balcony with reserve outlook.

Solar heating and power-saving light-bulbs throughout ensure energy efficiency. An established hedge in the backyard, creates a perfectly private haven for the kids, with an all-weather pergola overlooking level lawn and low maintenance gardens. A terrific family home in an enviable

4  2  2 

**View :** <https://www.gilmour.com.au/lease/nsw/hills/kellyville/residential/house/5618698>



**Gilmour Property Agents**  
**02 9899 3311**

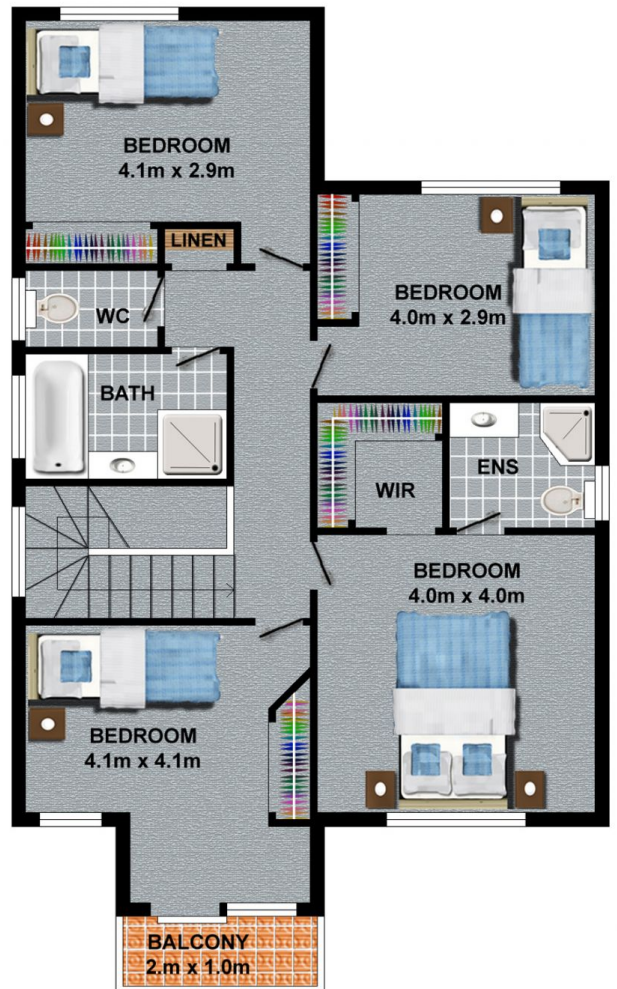
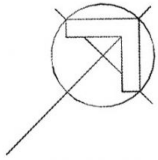

DISCLAIMER  
DIMENSIONS ARE APPROXIMATE AND SHOULD ONLY BE USED AS A GUIDE.  
THEY ARE NOT TO SCALE AND NO LIABILITY WILL BE ACCEPTED.