





CASTLE HILL

3  2  3 

Located on the second floor in a boutique complex of 21 is this beautiful spacious apartment with quality design and finishes throughout. Offering three large bedrooms all with built-in wardrobes and two bathrooms (including ensuite) with Villeroy & Boch soft closing toilets. Generous open plan living areas and entertain outside with the large wrap around terrace balconies fully tiled with covered pergola benefitting from a northerly aspect. Bring out your master chef in the gourmet polyurethane kitchen with CaesarStone benchtops and Miele appliances. Other great features include split air-conditioning unit, Grohe tapware, video intercom, double electronic lock-up garage with separate storage room and 24 hour surveillance to the basement. Total area of apartment is 229sqm approximately including terrace areas. Strata Levies of \$860.00 per quarter with no pool or gym in the complex there is no need to pay for unused amenities. Located only minutes walk from Castle

Building Size : 25 sqm
View : <https://www.gilmour.com.au/sale/nsw/hills/castle-hill/residential/unit/5619974>



Gilmour Property Agents
02 9899 3311

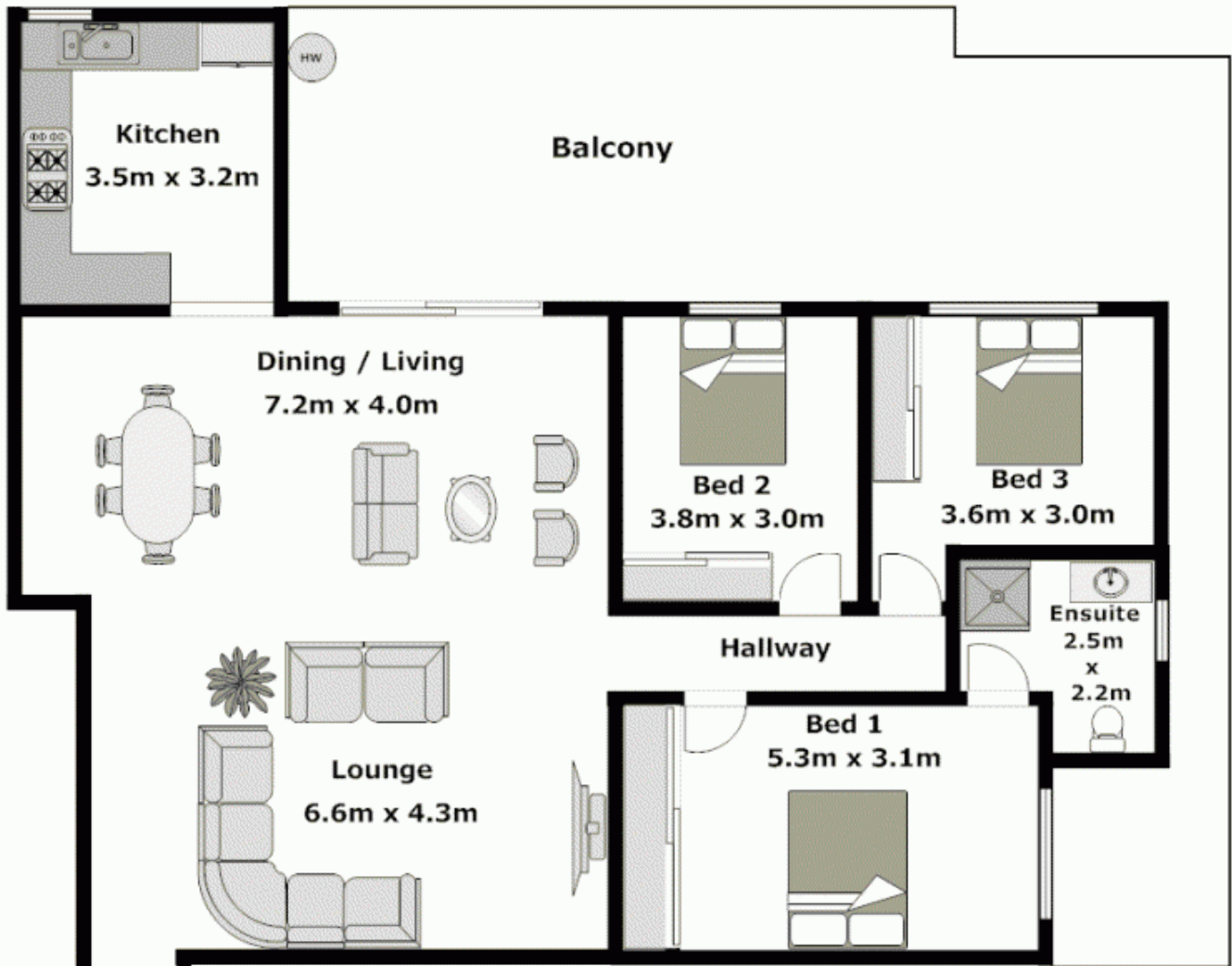

APPROXIMATE TOTAL FLOOR AREA: 231m² (25sq)

DISCLAIMER:

Whilst every attempt has been made to ensure the accuracy of the floor plan contained here, no responsibility is taken for any error, omission, or misstatement. This floor plan is intended as a guide only, for representation purposes only, and should be used as such by any prospective purchaser. No guarantee or warranties can be given, and any person using this information should rely on their own enquiries.

Hallway

Entry

