



CASTLE HILL

4  2  2 

Nestled on the high side of a quiet cul-de-sac is this well presented family home oozing character! Featuring four large bedrooms, three with built-ins and the master bedroom complete with a walk-in robe & ensuite with a spa bath. The 9 foot ceilings and polished Tallowood floors throughout create a warm ambience. Informal and formal areas including a separate lounge & dining room. Meals and living areas adjoin the Tasmanian Blackwood kitchen which has lots of bench space and a large walk-in pantry. Cedar doors lead out to a paved entertaining area in the private rear yard plus there are two undercover verandahs. Other features include a detached double garage, wall and ceiling insulation, 2 split system air conditioners, security alarm and lots of under house storage. All on a 719sqm block in a great family friendly street with house proud neighbours and easy access to Fred Caterson Reserve.

Land Size : 719 sqm

View : <https://www.gilmour.com.au/sale/nsw/hills/castle-hill/residential/house/5619986>



Craig Alexis
02 9899 3311

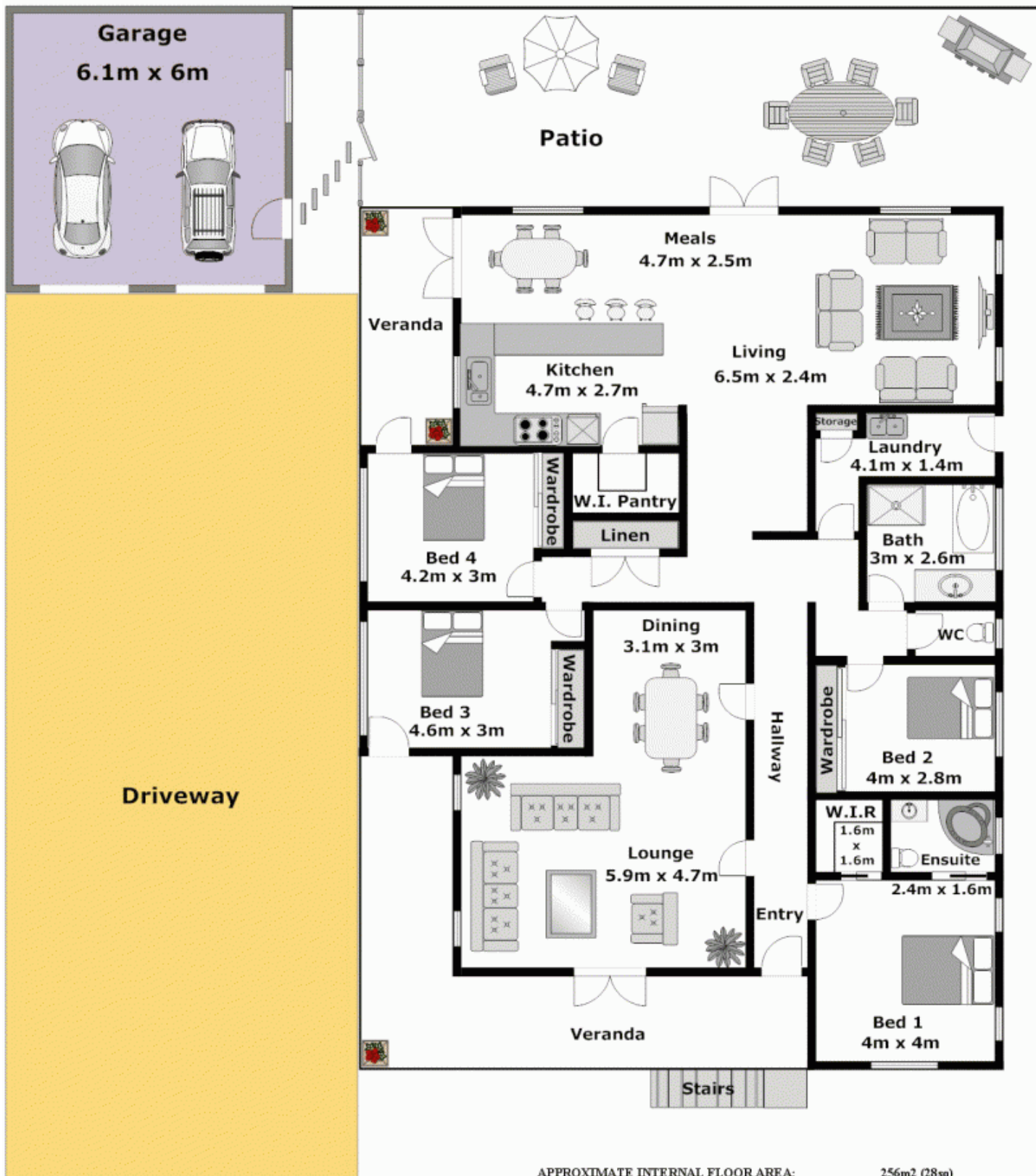

APPROXIMATE INTERNAL FLOOR AREA:
 APPROXIMATE GARAGE FLOOR AREA:

256m² (28sq)
 37m² (4sq)

APPROXIMATE TOTAL INTERNAL FLOOR AREA: 293m² (32sq)

DISCLAIMER:

Whilst every attempt has been made to ensure the accuracy of the floor plan contained here, no responsibility is taken for any error, omission, or misstatement. This floor plan is intended as a guide only, for representation purposes only, and should be used as such by any prospective purchaser. No guarantee or warranties can be given, and any person using this information should rely on their own enquiries.

