



## CASTLE HILL

4 2 3

Have you been looking for that perfect quality and stylish single level home only minutes from Castle Towers!! If so than look no further! This ten year old home with only one owner oozes street appeal and character occupying a 702sqm block in a cul-de-sac position. Offering four bedrooms or three plus study, three of the bedrooms are king size with built-in wardrobes and ensuite in master. A wealth of living and entertaining space includes formal dining, formal living room, open plan family and rumpus with meals area adjacent to the granite kitchen. Large paved rear entertainment area with private established gardens and verandah at the front to sit back & relax. Other features include ducted air-conditioning, alarm system, high 9 foot ceilings, water tanks with a total of 7500 litre storage, separate workshop and three car lock-up garage with loft storage.

SOLD 27th April, 2011

**Land Size** : 702 sqm  
**View** : <https://www.gilmour.com.au/sale/nsw/hills/castle-hill/residential/house/5620001>



**Gilmour Property Agents**  
**02 9899 3311**

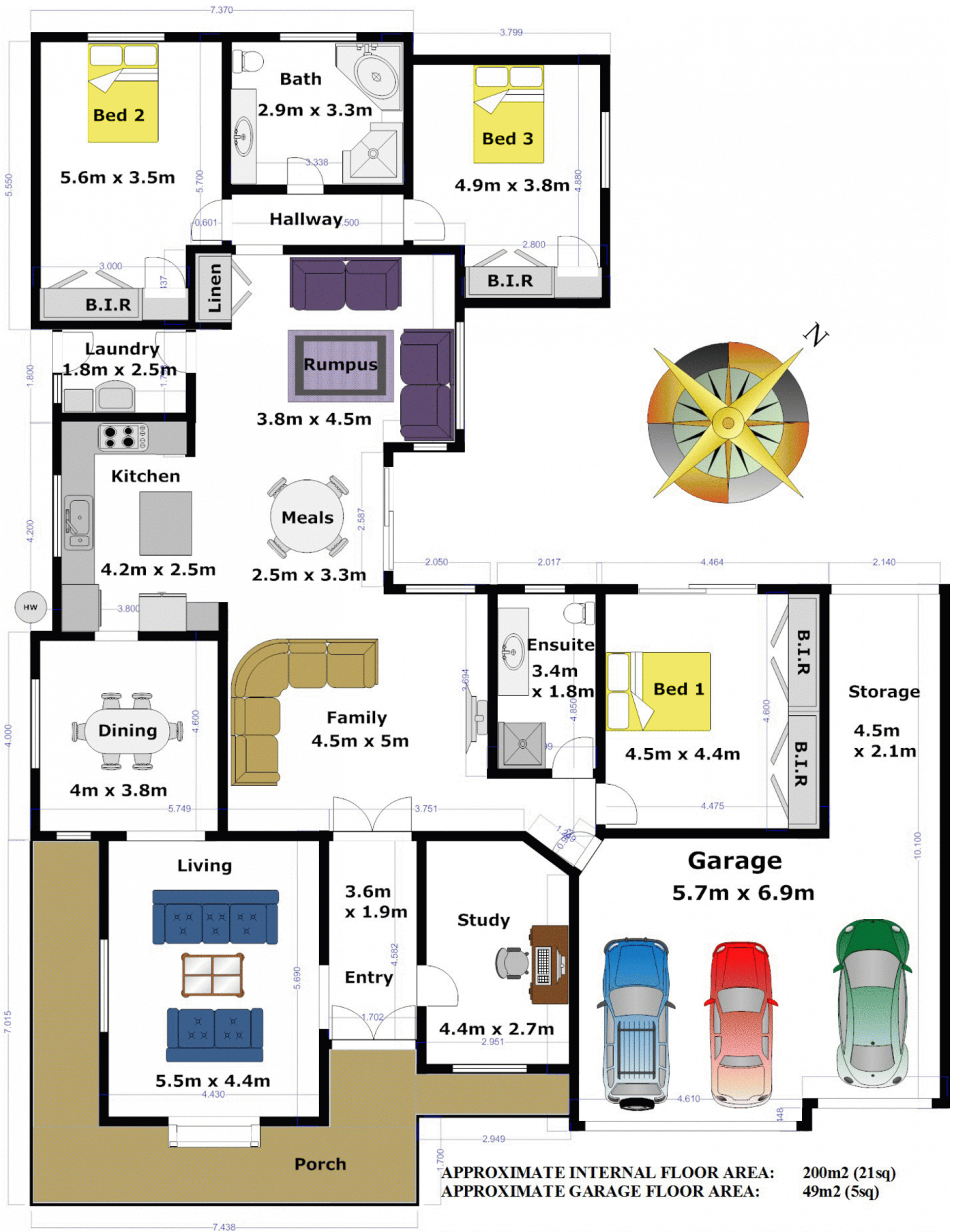

**APPROXIMATE TOTAL INTERNAL FLOOR AREA: 249m<sup>2</sup> (26sq)**

**DISCLAIMER:**

Whilst every attempt has been made to ensure the accuracy of the floor plan contained here, no responsibility is taken for any error, omission, or misstatement. This floor plan is intended as a guide only, for representation purposes only, and should be used as such by any prospective purchaser. No guarantee or warranties can be given, and any person using this information should rely on their own enquires.

