



CASTLE HILL

4 3 3

Fantastic home ideal for the growing family in a quiet cul-de-sac position in the sought after Kings Road Estate. This Masterbuilt creation from Lowrey Homes boasts four double bedrooms plus a study all with built in wardrobes and the master features a walk-in robe & ensuite. Great living space with the formal lounge & dining, family meals and large family relaxing room adjoining the gourmet Polyurethane & Granite gas kitchen. A rumpus room upstairs & downstairs caters to all the demands of a large family along with three garages and bathrooms. Creature comforts such as ducted air-conditioning & vacuum, two dishwashers & automatic garage and it has a low maintenance yard. On the high side position of the road plus situated in the Samuel Gilbert Public zoning area and surrounded by house proud quality homes, there isn't many available like this one... inspect today!!

SOLD 31st May, 2011

View : <https://www.gilmour.com.au/sale/nsw/hills/castle-hill/residential/house/5620003>



Craig Alexis
02 9899 3311

Upper Level

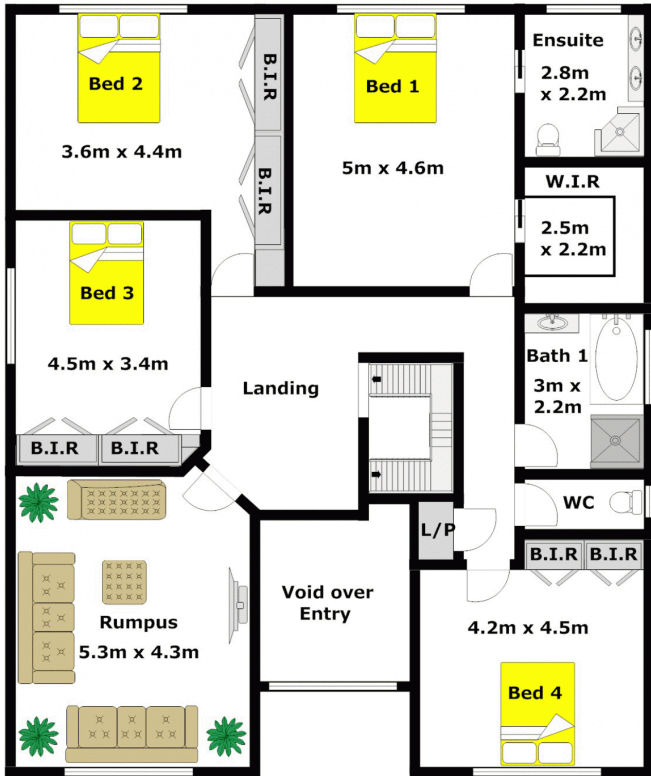

Lower Level

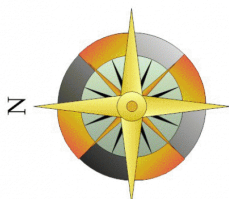
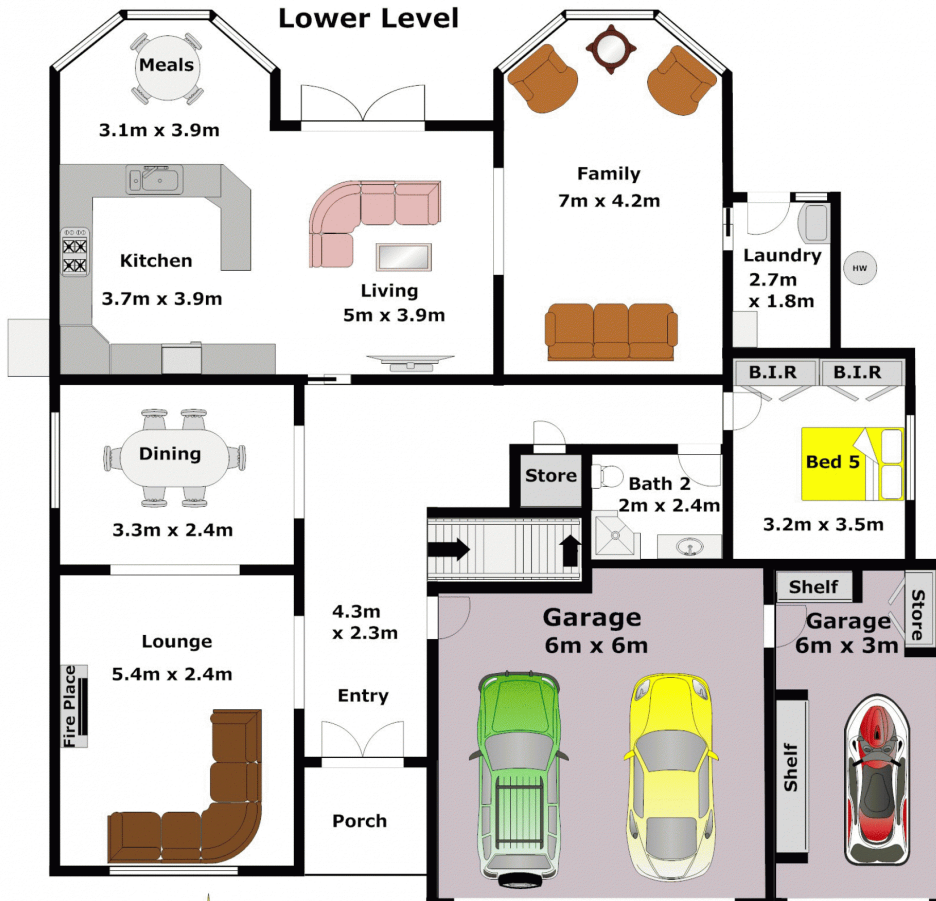

APPROXIMATE UPPER LEVEL FLOOR AREA: 150m² (16sq)
 APPROXIMATE LOWER LEVEL FLOOR AREA: 160m² (17sq)
 APPROXIMATE GARAGE FLOOR AREA: 54m² (6sq)

APPROXIMATE INTERNAL FLOOR AREA: 364m² (39sq)

DISCLAIMER:

Whilst every attempt has been made to ensure the accuracy of the floor plan contained here, no responsibility is taken for any error, omission, or misstatement. This floor plan is intended as a guide only, for representation purposes only, and should be used as such by any prospective purchaser. No guarantee or warranties can be given, and any person using this information should rely on their own enquires.