



BAULKHAM HILLS

4 2 4

This sensational single level family home in the heart of Crestwood is ideally located opposite a majestic park & reserve. Immaculately presented & maintained with four bedrooms and two updated bathrooms. Oodles of living space consisting of a lounge & dining, a family meals area and a separate rumpus room. The excellent renovated gas kitchen with Miele appliances makes cooking an ease while the ducted air-conditioning ensures pleasant temperatures all year round. Continue outside to a magnificent covered entertaining area with a heated spa to relax in or cool off in the refreshing salt water, in-ground swimming pool. The double lock up garage with internal access plus a double car port takes care of all the vehicles, toys & maybe the boat too! All this on 761sqm of land & located close to Crestwood Primary & High Schools and local shops. A great combination of features...move straight in & enjoy!! Inspect today

Land Size : 761 sqm
View : <https://www.gilmour.com.au/sale/nsw/hills/baulkham-hills/residential/house/5620024>



Craig Alexis
02 9899 3311

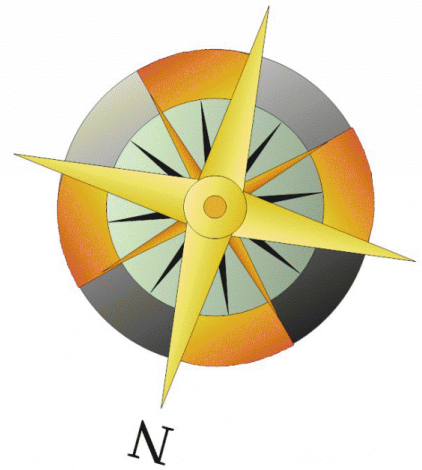
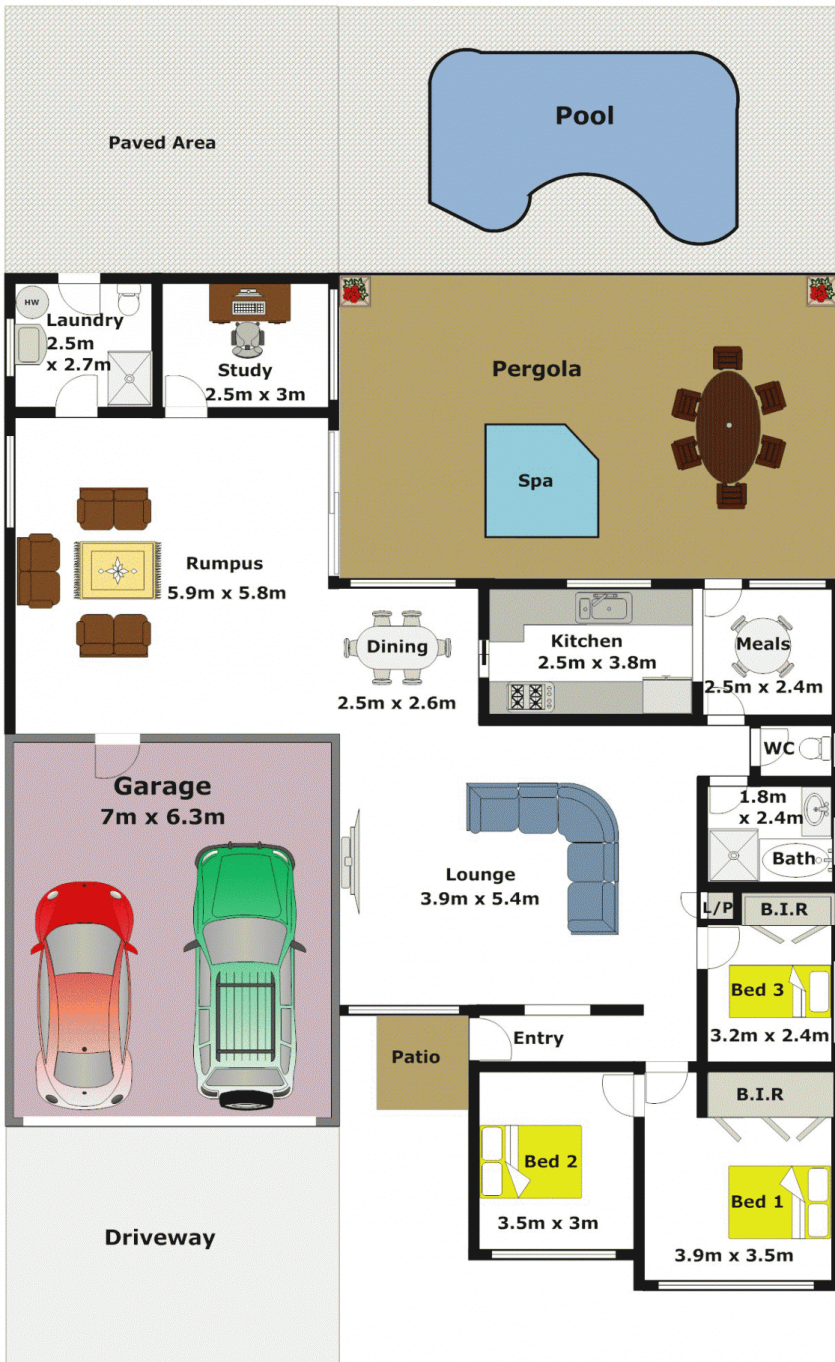

APPROXIMATE INTERNAL FLOOR AREA: 146m² (16sq)
 APPROXIMATE GARAGE FLOOR AREA: 44m² (5sq)

APPROXIMATE TOTAL FLOOR AREA: 190m² (21sq)

DISCLAIMER:

Whilst every attempt has been made to ensure the accuracy of the floor plan contained here, no responsibility is taken for any error, omission, or misstatement. This floor plan is intended as a guide only, for representation purposes only, and should be used as such by any prospective purchaser. No guarantee or warranties can be given, and any person using this information should rely on their own enquires.

