



## CASTLE HILL

4  2  2 

If you are looking for a home to fall in love with than this superior family home is the answer! Offering four generous bedrooms, with built-in wardrobes to three and the master bedroom boasts a walk-in robe, ensuite & parents retreat. Admire the 46 squares of living & entertaining space that include formal & informal space such as dining room, open plan entrance foyer that leads to the wide staircase and a rumpus on each level. The granite kitchen with gas cooking & polished tiles provides the perfect recipe for happy family feasts and there is an adjoining family room with meals area. Lovely north aspect to the rear yard that features a paved area for easy entertaining and a shed for those bits & pieces. Also featuring ducted air-conditioning & vacuum, large study, parquet flooring, alarm & intercom and double lock-up garage with internal access & drive through to the rear. All on a 600sqm block with a short distance to Kellyville Plaza, local schools and public transport including

**Building Size** : 46 sqm  
**Land Size** : 600 sqm  
**View** : <https://www.gilmour.com.au/sale/nsw/hills/castle-hill/residential/house/5620025>



**Gilmour Property Agents**  
**02 9899 3311**

## Upper Level

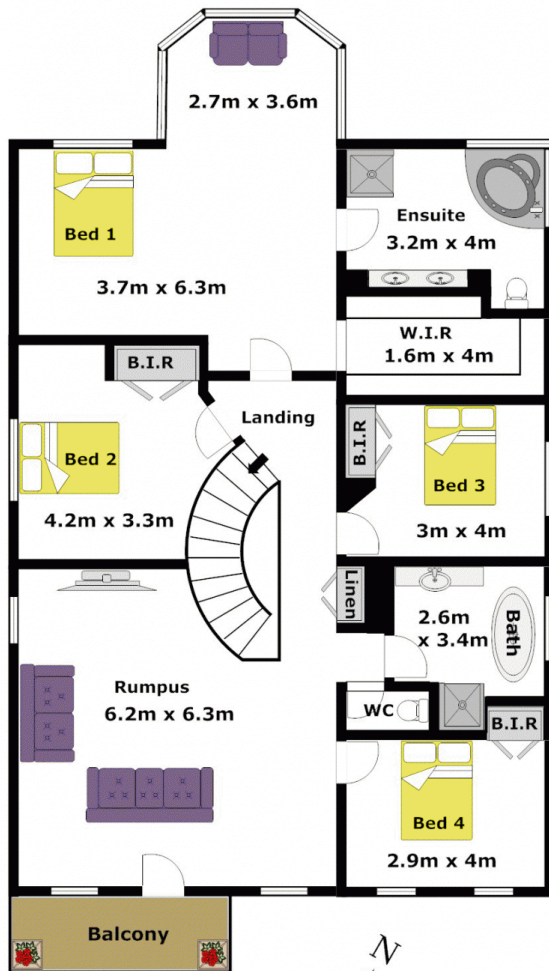

## Lower Level

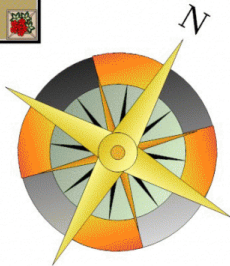

APPROXIMATE LOWER LEVEL FLOOR AREA: 316m<sup>2</sup> (34sq)  
 APPROXIMATE UPPER LEVEL FLOOR AREA: 158m<sup>2</sup> (17sq)  
 APPROXIMATE GARAGE FLOOR AREA: 36m<sup>2</sup> (4sq)

**APPROXIMATE INTERNAL FLOOR AREA: 510m<sup>2</sup> (55sq)**

### DISCLAIMER:

Whilst every attempt has been made to ensure the accuracy of the floor plan contained here, no responsibility is taken for any error, omission, or misstatement. This floor plan is intended as a guide only, for representation purposes only, and should be used as such by any prospective purchaser. No guarantee or warranties can be given, and any person using this information should rely on their own enquires.

