



CASTLE HILL

2  2  2 

This fantastic, very modern apartment set in a prestigious building complex built in 2007 is not to be missed by discerning buyers! The apartment is set on the third level and is well decorated & presented and offers two large bedrooms with built-in wardrobes plus two bathrooms including ensuite. With an open plan layout & contemporary CaesarStone kitchen with dishwasher and gas cooking. The enormous covered, fully tiled balcony with an open outlook is perfect for outdoor entertaining & dining. The double lock-up garage with an 8m depth has exceptional additional storage that gives a total area of 172 sqm (approx), plus alarm system and the two split-system air-conditioners provide temperature control & comfort. All part of a security building with lift access only minutes from central Castle Hill and all it has to offer. This is a fantastic buying opportunity and it **MUST BE SOLD!**

Building Size : 19 sqm
View : <https://www.gilmour.com.au/sale/nsw/hills/castle-hill/residential/unit/5620056>



Gilmour Property Agents
02 9899 3311

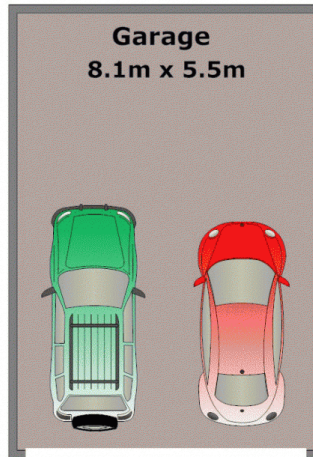
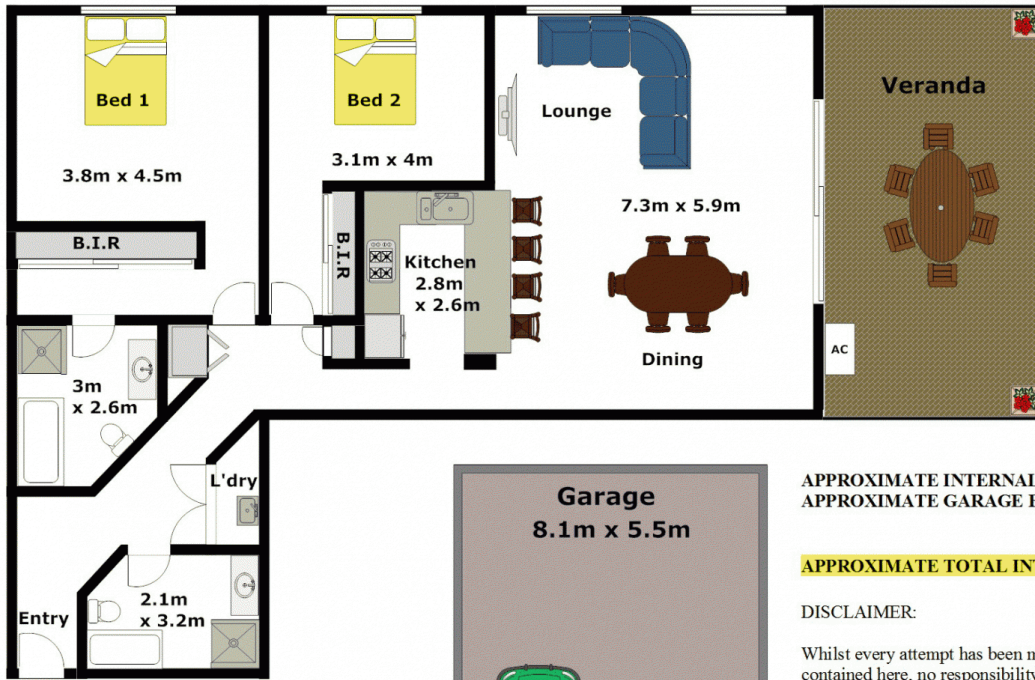

APPROXIMATE INTERNAL FLOOR AREA: 126m² (14sq)
 APPROXIMATE GARAGE FLOOR AREA: 46m² (5sq)

APPROXIMATE TOTAL INTERNAL FLOOR AREA: 172m² (19sq)

DISCLAIMER:

Whilst every attempt has been made to ensure the accuracy of the floor plan contained here, no responsibility is taken for any error, omission, or misstatement. This floor plan is intended as a guide only, for representation purposes only, and should be used as such by any prospective purchaser. No guarantee or warranties can be given, and any person using this information should rely on their own enquires.

