



## CASTLE HILL

4  2  2 

Set on a low maintenance block is this fantastic family home that enjoys the peace of the Fred Catterson reserve whilst the convenience of being only minutes to Castle Towers. Immaculately presented and recently painted throughout this house offers four large bedrooms with built-in wardrobes to all and a generous ensuite in the huge master bedroom. The spacious living areas include a formal lounge, separate formal dining and family room plus meals area adjoining the kitchen with gas cooking and plenty of cupboards. Enjoy the sunny aspect & lovely outlook whilst hosting summer barbeques from the near new Merbau timber deck that overlooks the tiered & established gardens with beautiful sandstone steps. Other great inclusions of African hardwood timber floors, loads of storage, ducted air conditioning, alarm, insulation to the ceiling, gas points, additional separate toilet and double lock-up garage with internal access. Situated in a tranquil &

**Land Size** : 542 sqm  
**View** : <https://www.gilmour.com.au/sale/nsw/hills/castle-hill/residential/house/5620087>



**Gilmour Property Agents**  
**02 9899 3311**

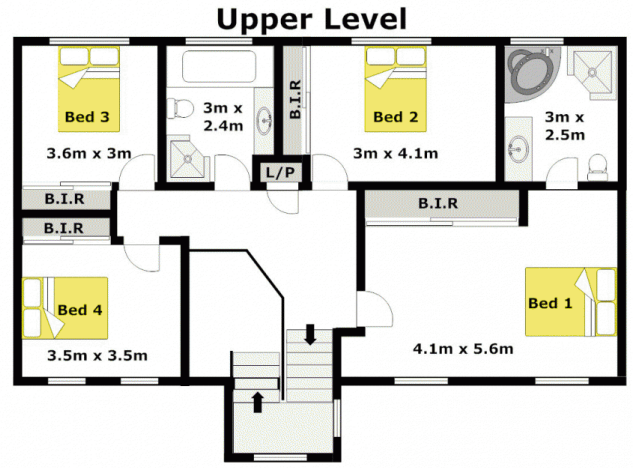
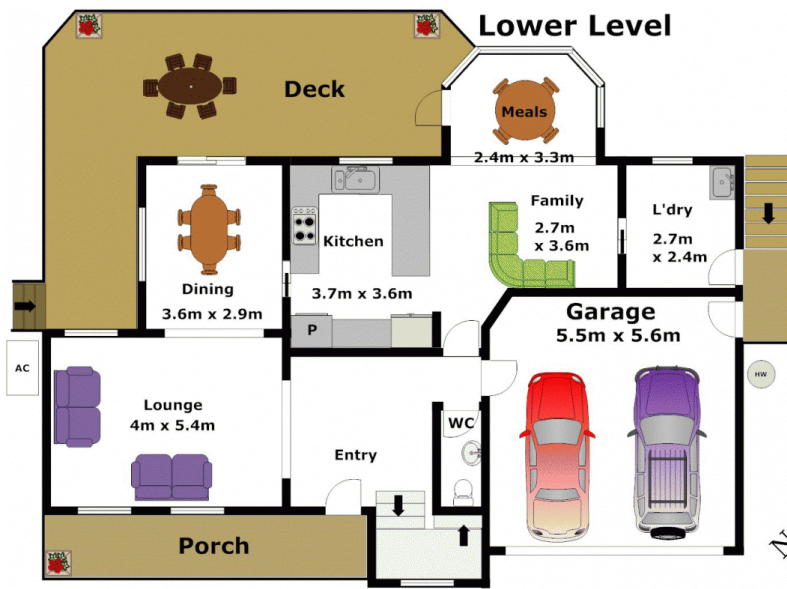

**DISCLAIMER:**

Whilst every attempt has been made to ensure the accuracy of the floor plan contained here, no responsibility is taken for any error, omission, or misstatement. This floor plan is intended as a guide only, for representation purposes only, and should be used as such by any prospective purchaser. No guarantee or warranties can be given, and any person using this information should rely on their own enquires.

