



## CASTLE HILL

4 2 1

Set on the high side of a quiet, leafy street is this neat family home on 758.8sqm providing a great entry point into the sought after Castle Hill market. Offering four bedrooms with built-in robes to all and a walk-in robe plus en-suite in the master bedroom. There is new paint & carpet throughout and spacious living areas of a lounge & dining room, separate rumpus and meals area adjacent to the open plan kitchen with a walk-in pantry. With a large & level backyard and oversized single lock-up garage. Conveniently close to all amenities including shops; schools; cinemas; RSL and public transport plus city bus-a home that is all about location, location, location!  
SOLD 3 December, 2012

**Land Size** : 758.8 sqm

**View** : <https://www.gilmour.com.au/sale/nsw/hills/castle-hill/residential/house/5620213>



**Gilmour Property Agents**  
**02 9899 3311**

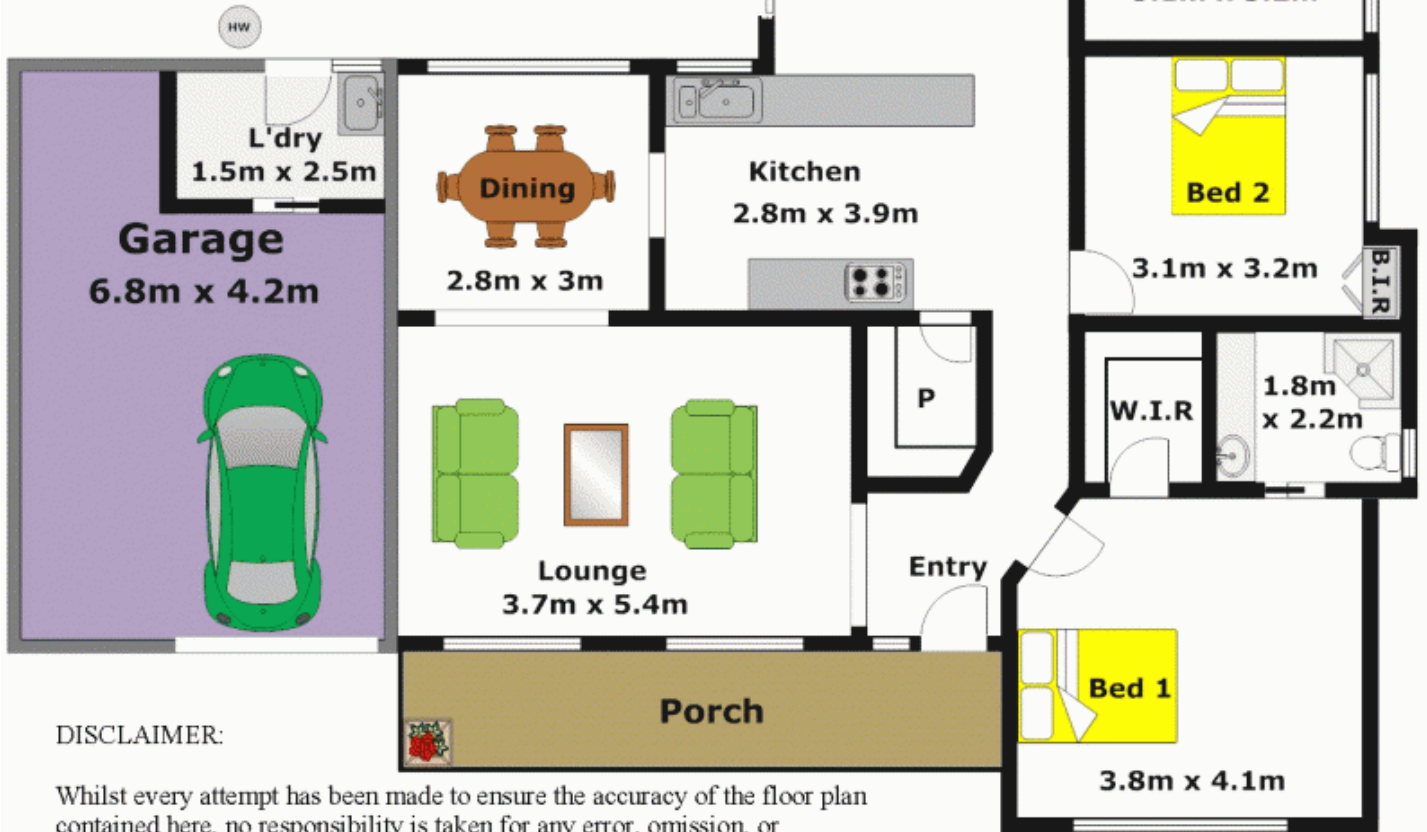

**DISCLAIMER:**

Whilst every attempt has been made to ensure the accuracy of the floor plan contained here, no responsibility is taken for any error, omission, or misstatement. This floor plan is intended as a guide only, for representation purposes only, and should be used as such by any prospective purchaser. No guarantee or warranties can be given, and any person using this information should rely on their own enquiries.