





## CASTLE HILL

Located on the high side of the street in the exclusive Castlewood Estate is this immaculately maintained, 12 year young single level Henley home. Set on a flat & square 832.7sqm block and offering four bedrooms with built-in wardrobes to three and an en-suite plus walk-in robe to the master bedroom. The high 10 foot ceilings throughout the home enhance the spacious living areas of a large formal lounge & dining room, open plan kitchen with adjoining meals area, separate study and a family/rumpus room. The outdoor, undercover entertaining area suits all occasions and conditions whilst the children will love to play in the large, private grassed backyard. Also boasting features such as double lock-up garage with internal access, ducted air-conditioning and additional separate toilet. This home is perfect for those looking to downsize or for a new home for their family and it is ideally located close to a schools, Castle Towers, parks and transport.

4  2  2 

**Land Size** : 832.7 sqm

**View** : <https://www.gilmour.com.au/sale/nsw/hills/castle-hill/residential/house/5620229>



**Gilmour Property Agents**  
**02 9899 3311**

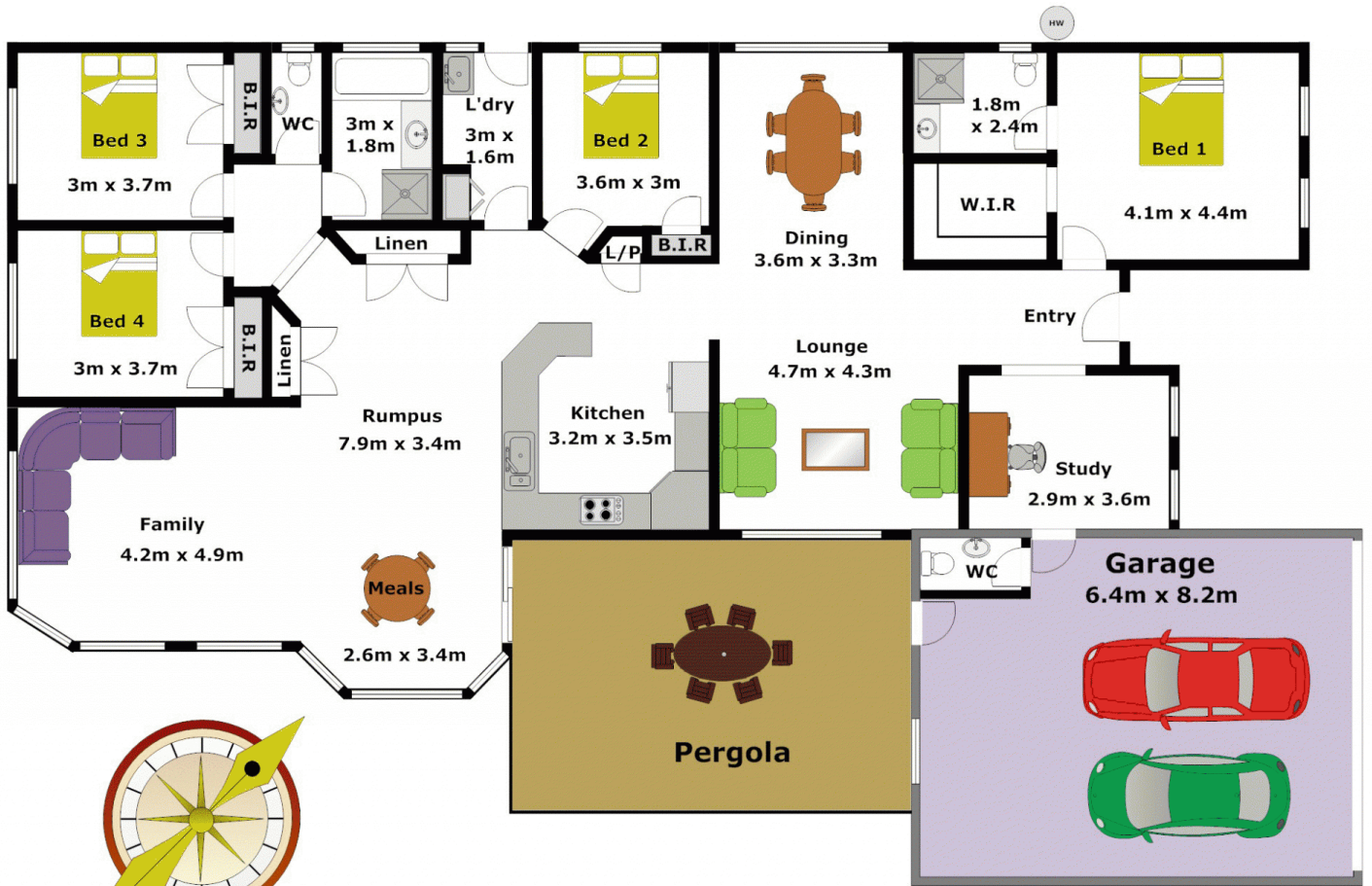

**DISCLAIMER:**

Whilst every attempt has been made to ensure the accuracy of the floor plan contained here, no responsibility is taken for any error, omission, or misstatement. This floor plan is intended as a guide only, for representation purposes only, and should be used as such by any prospective purchaser. No guarantee or warranties can be given, and any person using this information should rely on their own enquiries.

