



CASTLE HILL

4  3  2 

Located in a whisper quiet, sought after street is this lovely family home on a level 941sqm block with dual street access & so much to offer. Offering four bedrooms plus a separate study, with built-in robes to all bedrooms, a walk-in robe to the master bedroom and three updated bathrooms including the en-suite. The focus of the home is on spacious family living with a formal lounge room, separate rumpus/billiard room, a TV/family area and a meals/dining area adjoining the contemporary & updated kitchen. The perfect setting for entertaining is here with a covered & paved alfresco area that overlooks the sparkling in-ground pool with frameless glass fencing, and a level grassed yard for the active family. With other great features & inclusions of timber flooring, ducted air conditioning, alarm system, an oversized double lock up garage with a workshop area and side access ideal for the boat/caravan/tradesperson. Close & convenient to all

Land Size : 941 sqm
View : <https://www.gilmour.com.au/sale/nsw/hills/castle-hill/residential/house/5620242>



Gilmour Property Agents
02 9899 3311



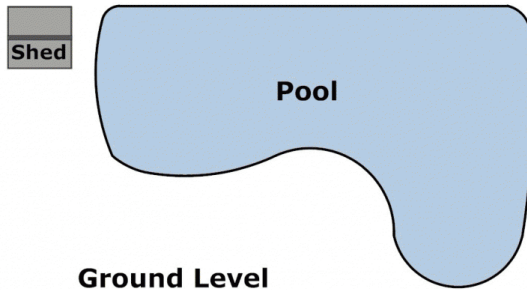

DISCLAIMER:

Whilst every attempt has been made to ensure the accuracy of the floor plan contained here, no responsibility is taken for any error, omission, or misstatement. This floor plan is intended as a guide only, for representation purposes only, and should be used as such by any prospective purchaser. No guarantee or warranties can be given, and any person using this information should rely on their own enquiries.

Ground Level

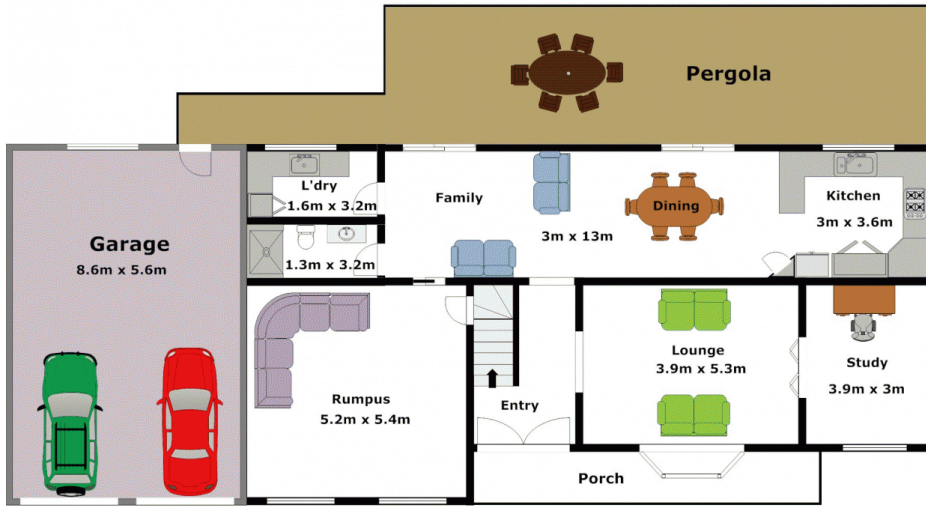

Upper Level

