



## CASTLE HILL

3  1  1 

Situated in a quiet cul-de-sac in the sought after East Excelsior location is where you will find this modern family home on a 727sqm block. Offering three bedrooms, with built-in robes to two. Stylish tiled bathroom with spa and additional toilet in laundry. The kitchen is modern and leads directly out onto the rear covered decking making this the perfect little entertainer. A large grassed backyard for the kids which is completely fenced and more importantly... its private! Solar panels, oversized lock up garage with mezzanine storage above, and conveniently located within walking distance to City/North Sydney/Parramatta bus stop. SOLD 24 April, 2013

**Land Size** : 727 sqm  
**View** : <https://www.gilmour.com.au/sale/nsw/hills/castle-hill/residential/house/5620256>



**Gilmour Property Agents**  
**02 9899 3311**

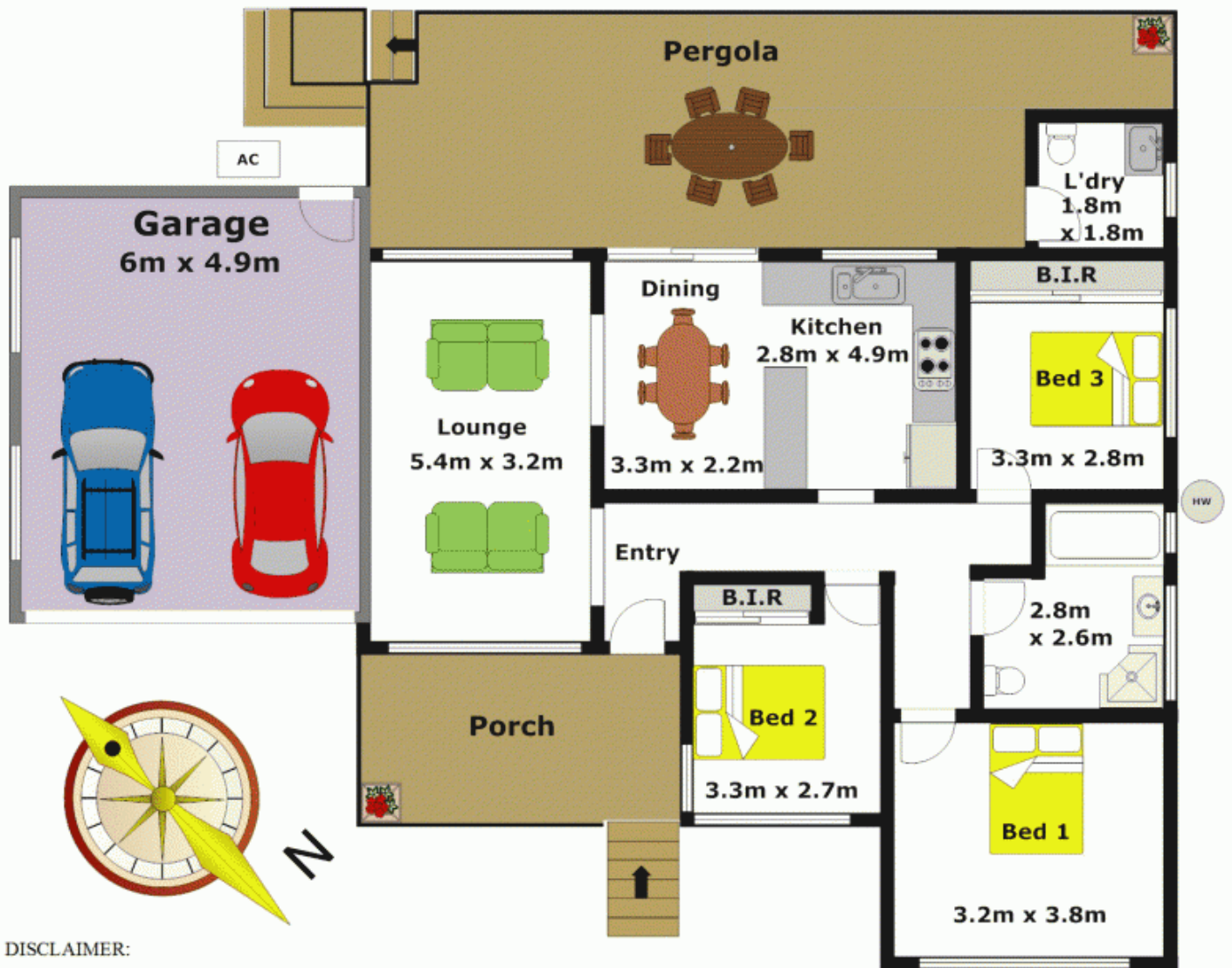

**DISCLAIMER:**

Whilst every attempt has been made to ensure the accuracy of the floor plan contained here, no responsibility is taken for any error, omission, or misstatement. This floor plan is intended as a guide only, for representation purposes only, and should be used as such by any prospective purchaser. No guarantee or warranties can be given, and any person using this information should rely on their own enquiries.



**Gilmour**  
PROPERTY AGENTS