





22 Gooraway Drive CASTLE HILL NSW

4  3  2 

Sitting in a quiet cul-de-sac in a sought after locale is this stunning family home on a light & bright 766.3sqm block. Offering four generous bedrooms, all with built-ins, a separate study and two bathrooms including the en-suite to the master bedroom. The focus is on stylish family living with the formal lounge & dining room, a separate rumpus room and a meals area adjoining the refurbished kitchen with new appliances and granite bench tops & splashbacks. The perfect environment for entertaining is here with the lovely rear deck & grassed yard that takes in the sunny aspect and the tranquil bush outlook. Other great features of this home include reverse cycle ducted air-conditioning and a generous tandem lock-up garage. Conveniently close to Samuel Gilbert Public, Knightsbridge shops, reserves and public transport-a home not to be missed!

SOLD 16 July, 2013

Land Size : 766.3 sqm

View : <https://www.gilmour.com.au/sale/nsw/hills/castle-hill/residential/house/5620294>



Gilmour Property Agents
02 9899 3311

Ground Level



Upper Level

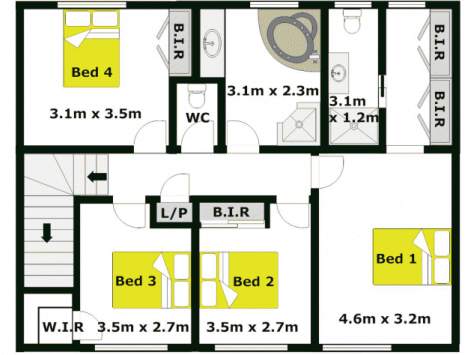

Gilmour
PROPERTY AGENTS



DISCLAIMER:

Whilst every attempt has been made to ensure the accuracy of the floor plan contained here, no responsibility is taken for any error, omission, or misstatement. This floor plan is intended as a guide only, for representation purposes only, and should be used as such by any prospective purchaser. No guarantee or warranties can be given, and any person using this information should rely on their own enquiries.