



106 Fishburn Crescent CASTLE HILL NSW

4 🚗 3 🚗 3 🚗

Sitting in a desirable, quiet street is this sizable family home on a generous & private 947.6sqm block. Boasting four bedrooms with built-in robes to two and a walk-in robe plus an en-suite to the master bedroom. The polished bamboo floorings compliment the light filled formal lounge & dining room and there is also comfortable living space of a rumpus room with a combustion fireplace and a meals area off the updated kitchen. Enjoy the freedom to entertain year round with the undercover area that overlooks the inviting, in-ground pool with solar heating and grassed yard. Other great features include new carpeting throughout, an oversized triple lock-up garage with internal access, split air-conditioning units, a fully renovated main bathroom, third bathroom downstairs and solar electricity & hot water. Close to shops, public transport including city bus, schools, Castle Towers, parks and cinemas. Make this home a very special part of family memories, inspect today!

Land Size : 946.6 sqm

View : <https://www.gilmour.com.au/sale/nsw/hills/castle-hill/residential/house/5620367>



Gilmour Property Agents
02 9899 3311

Upper Level

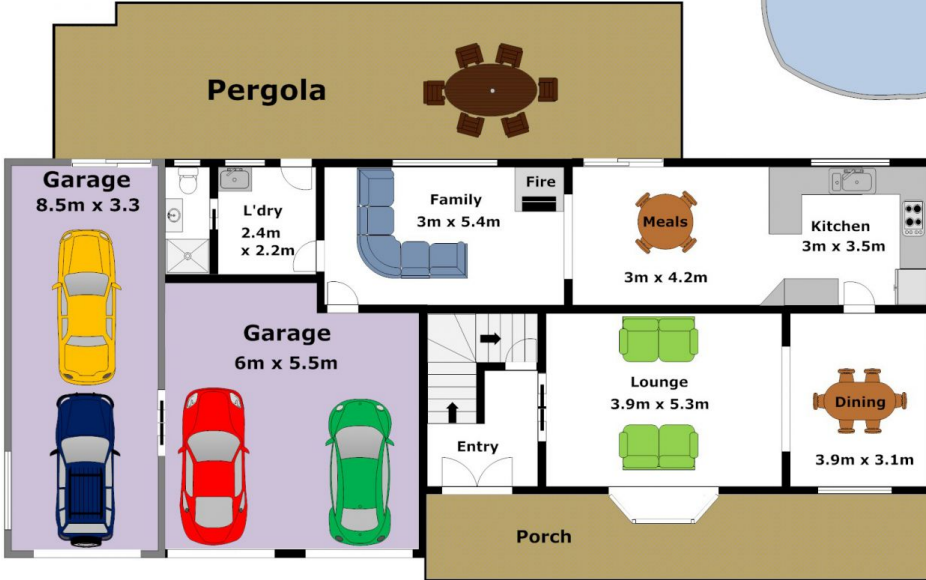
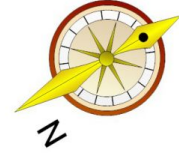
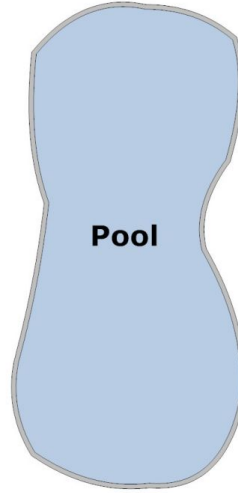
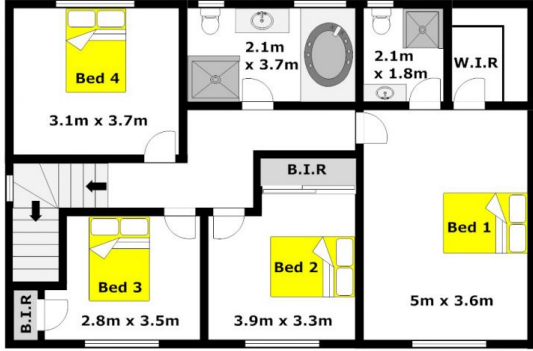

DISCLAIMER:

Whilst every attempt has been made to ensure the accuracy of the floor plan contained here, no responsibility is taken for any error, omission, or misstatement. This floor plan is intended as a guide only, for representation purposes only, and should be used as such by any prospective purchaser. No guarantee or warranties can be given, and any person using this information should rely on their own enquiries.