



## 10 La Vista Grove CASTLE HILL NSW

4  2  2 

Looking for an immaculate, single level home in a quiet grove on a low maintenance 740sqm block within easy access to all essential amenities? Well here it is! This lovely home offers four bedrooms, with the master bedroom boasting a walk-in robe plus en-suite and the other three bedrooms all have built-in wardrobes. There is great living space comprising of formal lounge & dining areas and a family/meals area off the updated CaesarStone kitchen with Smeg appliances and plenty of preparation area plus cupboards/drawers for storage. The light and spacious rumpus room is ideal for the kids toys & gadgets and overlooks a very private backyard. Relax under the covered patio and enjoy the warmth & light from the lovely north aspect to the grassed backyard with established, beautiful gardens. The carpet & paint are like new and there is an automatic double lock-up garage with internal access. Temperature control is provided by the

**Land Size** : 740.5 sqm

**View** : <https://www.gilmour.com.au/sale/nsw/hills/castle-hill/residential/house/5620406>



**Craig Alexis**  
02 9899 3311

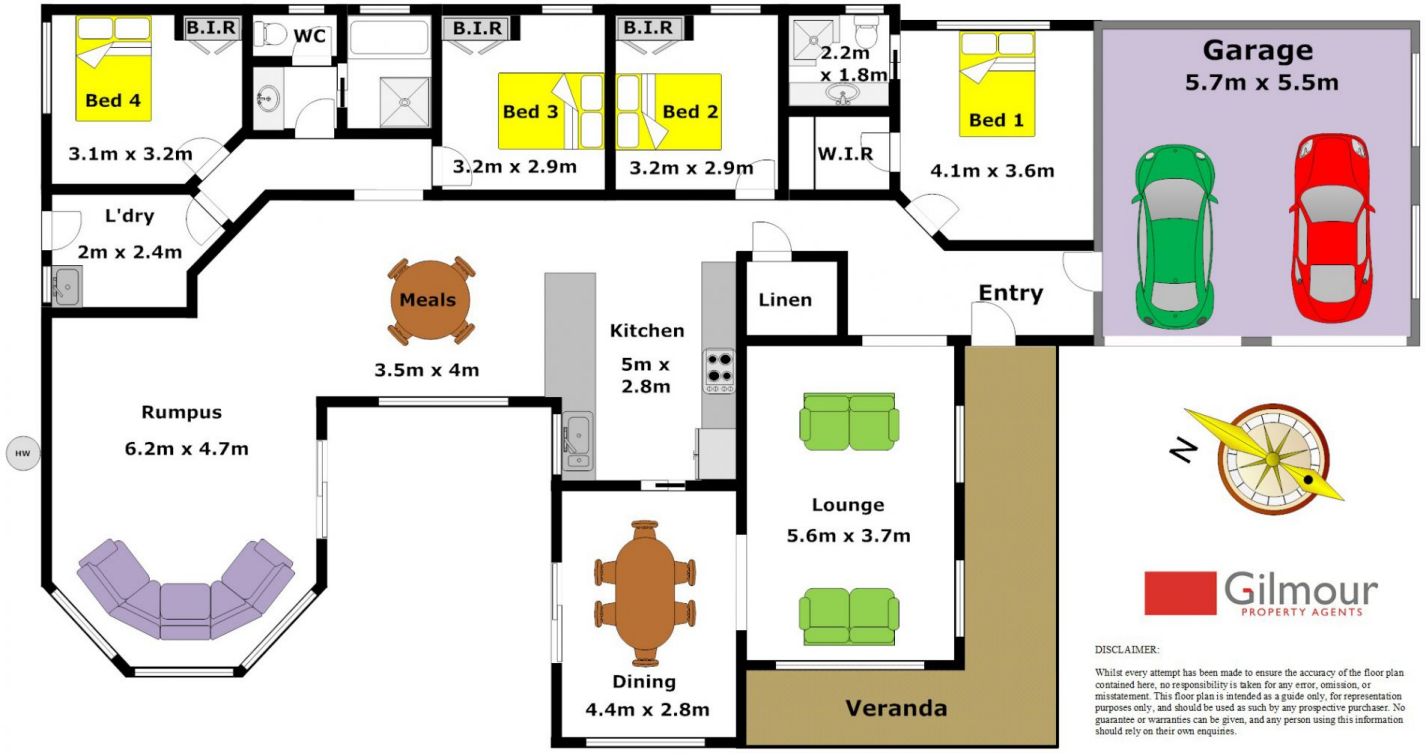

**DISCLAIMER:**  
Whilst every attempt has been made to ensure the accuracy of the floor plan contained here, no responsibility is taken for any error, omission, or misstatement. This floor plan is intended as a guide only, for representation purposes only, and should be used as such by any prospective purchaser. No guarantee or warranties can be given, and any person using this information should rely on their own enquiries.