



22 Yerriabah Place CASTLE HILL NSW

5 🛏 3 🚿 3 🚗

This fantastic and spacious family home is nestled in a lovely, quiet cul-de-sac within a desirable pocket of Castle Hill and in the much sought after Samuel Gilbert catchment. Set on 965.5sqm and featuring five bedrooms plus a separate study, four of the bedrooms have built-in robes and the generous master suite boasts a walk-in robe plus an en-suite. Family living prerequisites have been catered for with the formal lounge and dining room, a separate rumpus room and an open plan meals area adjoining the spacious kitchen. There is also potential in-law accommodation or a teenagers retreat with a bedroom, bathroom and storeroom/extra study. The home emphasises year round entertaining with the inviting and solar heated indoor pool that takes in the view of the paved alfresco area and lovely lawns with established gardens. To finish off the features offered here include a ducted vacuum system, air-conditioning, fireplaces, two garden

Land Size : 965.5 sqm

View : <https://www.gilmour.com.au/sale/nsw/hills/castle-hill/residential/house/5620412>



Gilmour Property Agents
02 9899 3311

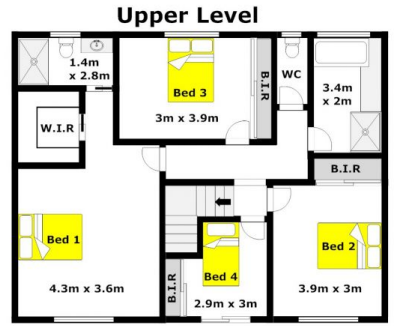
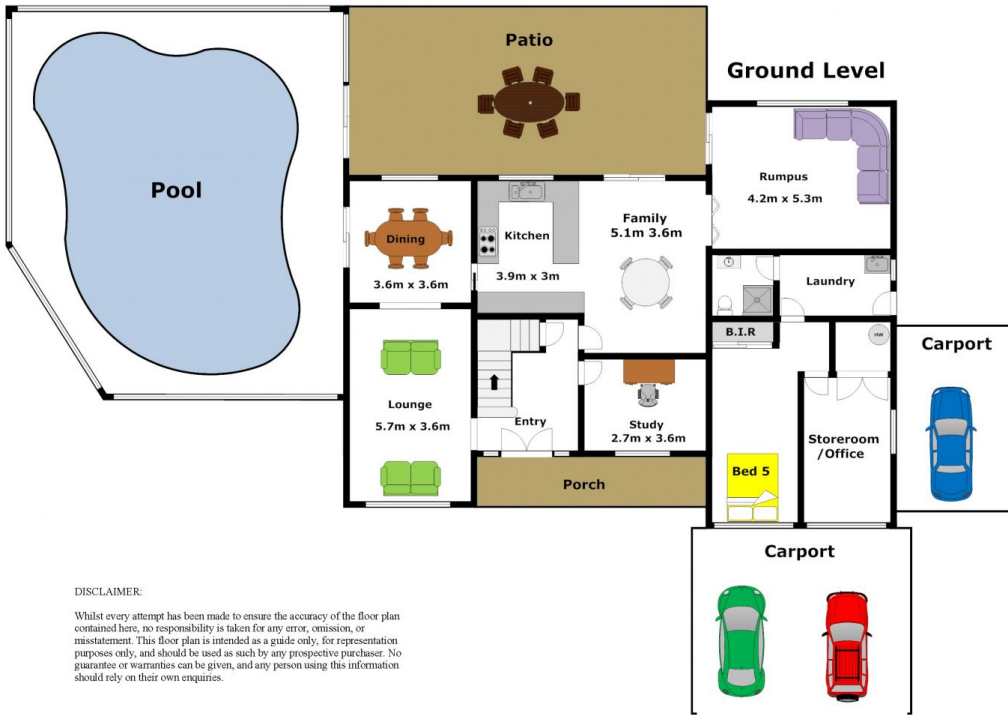

DISCLAIMER:

Whilst every attempt has been made to ensure the accuracy of the floor plan contained here, no responsibility is taken for any error, omission, or misstatement. This floor plan is intended as a guide only, for representation purposes only, and should be used as such by any prospective purchaser. No guarantee or warranties can be given, and any person using this information should rely on their own enquiries.