



22 Shelly Crescent BEAUMONT HILLS NSW

4  2  2 

Welcome to this warm & inviting family home that has been tastefully renovated throughout and boasts a stunning street presence. Situated on a 665.2sqm block in the heart of Beaumont Hills and featuring warm, neutral tones throughout which are enhanced by the new carpet, new paint and new blinds. There are four large bedrooms, three upstairs with built-in robes to each and the master suite that is positioned on the lower level is completed by a walk-in robe & a new en-suite. Loads of natural flows within the home and there is a wealth of living space that includes a large formal lounge room boasting a cosy open fireplace, a large formal dining area and an upstairs teenagers retreat. The modern kitchen is welcoming and stylish & features stone bench tops as well as gas cooking and flows out to an open plan family/meals room. Elegant entertaining is a breeze from the extensive paved & covered area and there is a grassed yard for the children

Land Size : 665.2 sqm

View : <https://www.gilmour.com.au/sale/nsw/hills/beaumont-hills/residential/house/5620479>



Gilmour Property Agents
02 9899 3311

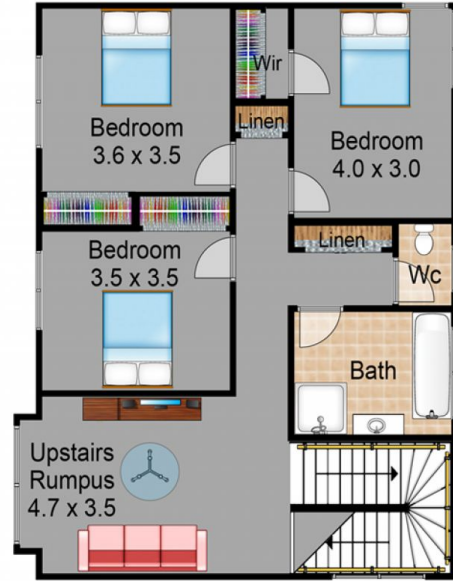

First Floor



Ground Floor

DISCLAIMER
DIMENSIONS ARE APPROXIMATE AND SHOULD ONLY BE USED AS A GUIDE.
THEY ARE NOT TO SCALE AND NO LIABILITY WILL BE ACCEPTED.