



9 Hume Street KELLYVILLE RIDGE NSW

3  2  2 

Immaculate in all ways, this dual level home on the high side of a quiet street, features three bedrooms and a study retreat upstairs. Only two years old, this stylish home is located on the fringe of The Ponds and within walking distance to Stanhope Village Shopping Centre and several local schools. All bedrooms have built-ins, the main with walk-in robe plus an ensuite. The gourmet ceasar stone kitchen has gas cooking, with the meals/family space adjoining the kitchen and flowing out to the covered alfresco entertainment area with established, well maintained, private gardens. A separate lounge room, ducted air conditioning, two bathrooms with a total of three toilets, a spa bath in the main bathroom, a double lock up garage with an automatic door, and 2.5KW solar roof panels all add to the long list of features. Beautifully presented with high 9ft ceilings, a large front entry door and fully tiled downstairs living areas - a property sure to

Land Size : 300 sqm
View : <https://www.gilmour.com.au/sale/nsw/hills/kellyville-ridge/residential/house/5620541>



Gilmour Property Agents
02 9899 3311

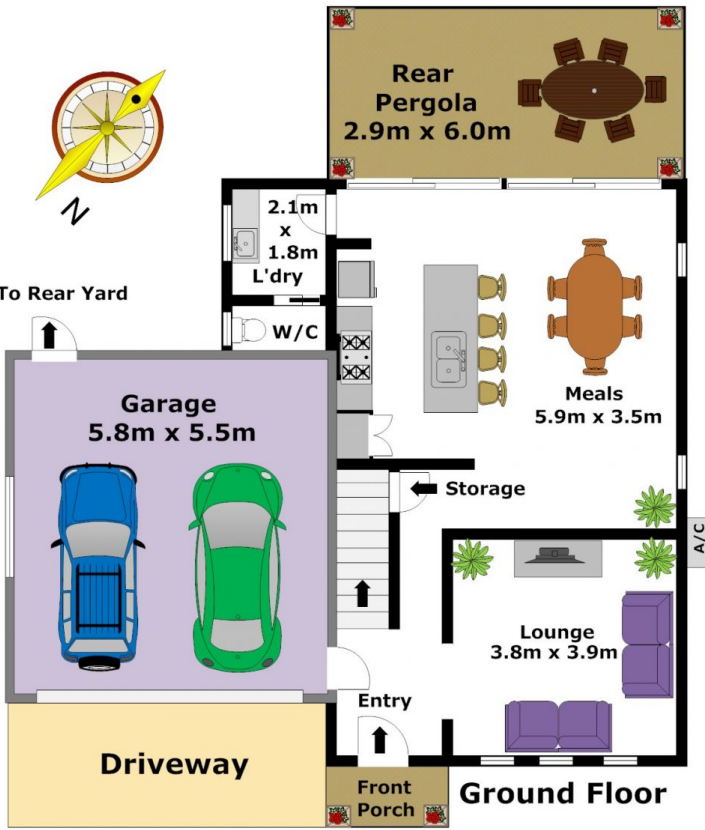

DISCLAIMER:

Whilst every attempt has been made to ensure the accuracy of the floor plan contained here, no responsibility is taken for any error, omission, or misstatement. This floor plan is intended as a guide only, for representation purposes only, and should be used as such by any prospective purchaser. No guarantee or warranties can be given, and any person using this information should rely on their own enquiries.

