



2 Talisman Avenue CASTLE HILL NSW

4 2 2

This handsome family home sits high and proud on a corner with views of Alfred Whaling Memorial Reserve with Rose Garden and oval. Located in the popular Roxborough Park Estate, this immaculate property is within walking distance of sought after schools and Waves Swimming Centre and gym.

- The dan designed Tasmanian Oak kitchen has a generous amount of cupboards and drawers with granite benches and splash backs and includes an eat-in area flowing through to a generous lounge and dining room and sunny balcony.

- Enjoy a barbeque under the covered and paved entertainment area whilst overlooking the glorious colourful gardens, fountain and manicured grass area. There is also side access available.

- Also with a renovated main bathroom and separate toilet with under floor heating and heated towel rail, ducted air

Land Size : 695.6 sqm

View : <https://www.gilmour.com.au/sale/nsw/hills/castle-hill/residential/house/5620619>



Craig Alexis
02 9899 3311

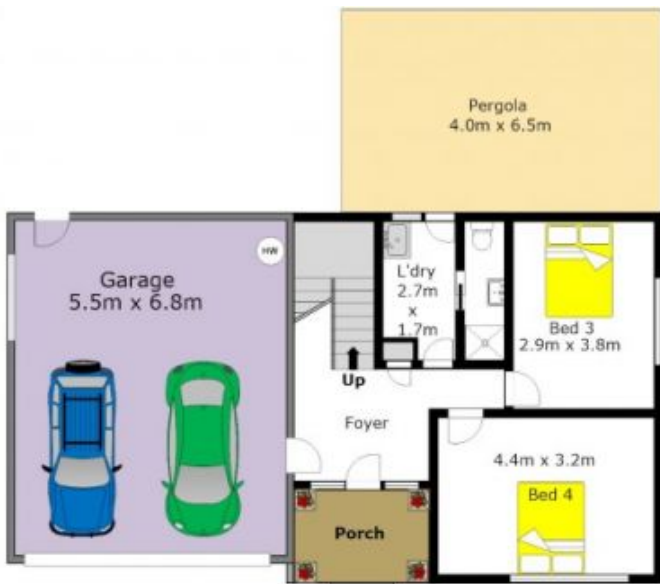

Ground Floor



DISCLAIMER:

While every attempt has been made to ensure the accuracy of the floor plan contained here, no responsibility is taken for any error, omission, or misstatement. This floor plan is intended as a guide only, for representation purposes only, and should be used as such by any prospective purchaser. No guarantee or warranty can be given, and any person using this information should rely on their own enquiries.



First Floor