



68 First Farm Drive CASTLE HILL NSW

5 4 3

Appreciate the beauty and build quality of this amazing tri-level home located in the sought-after First Farm Drive Estate. In a fantastic location within walking distance to the future North West Rail Link, Oakhill College and all amenities including schools, parks and transport, this beautifully presented home is the ultimate in lifestyle living.

- Living areas include formal lounge and dining rooms, informal dining and rumpus room making it the perfect home for the growing family in need of plenty of space.

- Entertain in style with breathtaking sunsets and views of the Blue Mountains from your large covered decking area which overlooks a great sized grassed yard perfect for kids to run and play and an inground pool and spa with solar heating.

- Other creature comforts include ducted air-conditioning, ducted vacuum, triple lock-up garage and a downstairs granny flat with large rumpus/billiard room leading to the

Land Size : 901.1 sqm

View : <https://www.gilmour.com.au/sale/nsw/hills/castle-hill/residential/house/5620644>



Gilmour Property Agents
02 9899 3311

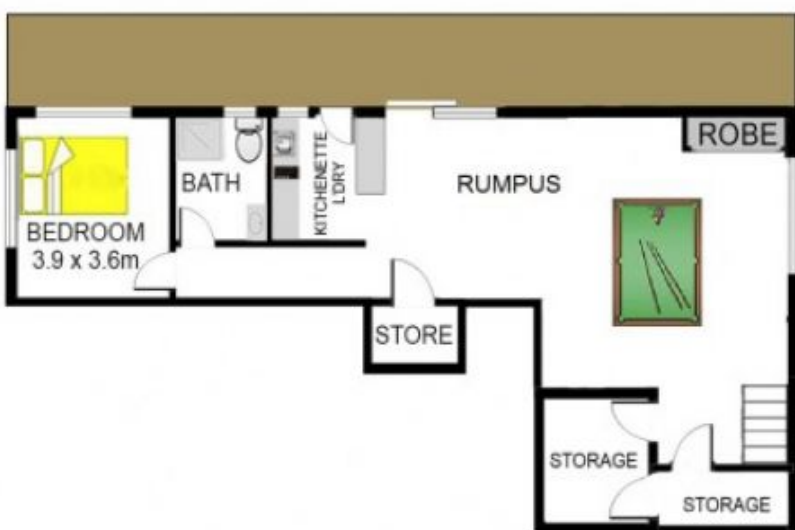
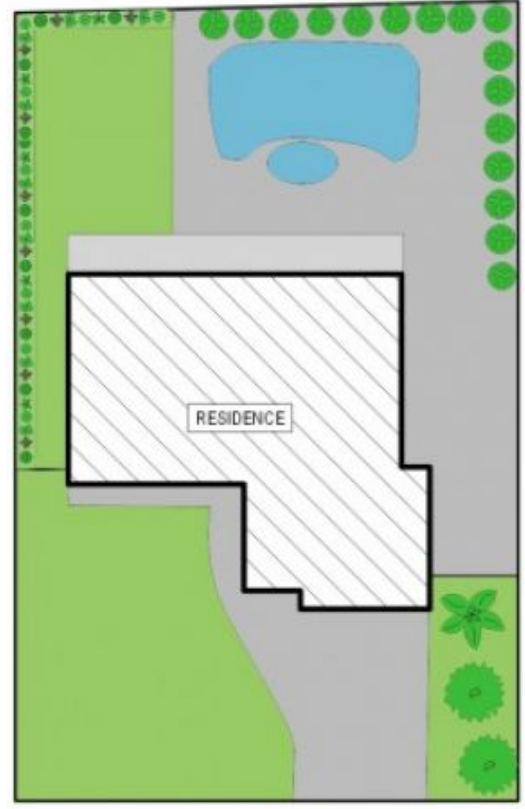

68 FIRST FARM DRIVE, CASTLE HILL

DISCLAIMER
 DIMENSIONS ARE APPROXIMATE AND SHOULD ONLY BE USED AS A GUIDE
 THEY ARE NOT TO SCALE AND NO LIABILITY WILL BE ACCEPTED.

