



## 66 Hilda Road BAULKHAM HILLS NSW

3  1  1 

Located in the Matthew Pearce Catchment, in central Baulkham Hills, this home is perfect for families who are seeking a great location and peaceful setting. This property boasts a large 714sqm block set on the high side of the road, overlooking a lovely park, and close to all amenities!

- Featuring three bedrooms with a built-in wardrobe and study to the master. Brand new kitchen, complete with quality stainless steel appliances and gas cooking, to get creative in. Polished floor boards give a contemporary feel and the living spaces consist of a lounge room, separate dining room, and a family relaxing area.

- Continue out to the fully fenced grassed yard with a covered patio for outdoor entertaining and a couple of sheds to store all the accumulated gear. The roof has also been replaced saving you time and money.

- The existing tenant would like to stay on or you could move in after the 14th April. Inspect sooner than later

**Land Size** : 714 sqm

**View** : <https://www.gilmour.com.au/sale/nsw/hills/baulkham-hills/residential/house/5620646>



**Craig Alexis**  
02 9899 3311

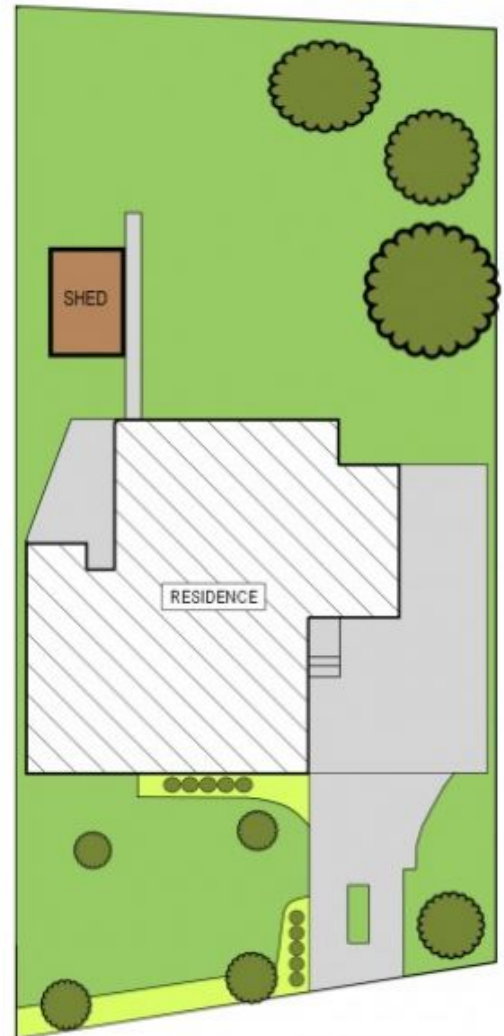

## 66 Hilda Road, Baulkham Hills

**DISCLAIMER**  
DIMENSIONS ARE APPROXIMATE AND SHOULD ONLY BE USED AS A GUIDE  
THEY ARE NOT TO SCALE AND NO LIABILITY WILL BE ACCEPTED.

