



67 Castle Street CASTLE HILL NSW

3 1 2

It's all about location! Situated on a spectacular 1113sqm, level block, and within walking distance to Castle Towers, the new North West rail link, Castle Hill RSL Club, Castle Hill primary/high schools, and Castle Hill Library, you will have everything at your door.

- Featuring a northerly aspect, three modest bedrooms and cottage charm, this home displays excellent investment potential.

- The current zoning is R3 Medium density and the land dimensions are approximately 60.96m x 18.29m - unlock the future potential this property has to offer!

- Rarely do we see properties of this land area and location available, don't miss the opportunity to own this tightly held real estate.

Land Size : 1113 sqm

View : <https://www.gilmour.com.au/sale/nsw/hills/castle-hill/residential/house/5620672>



Gilmour Property Agents
02 9899 3311

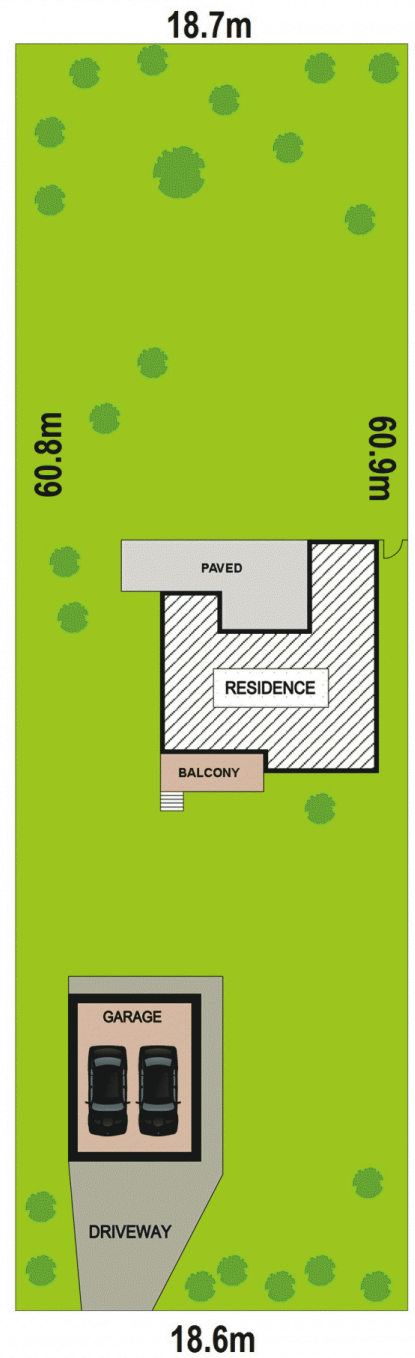
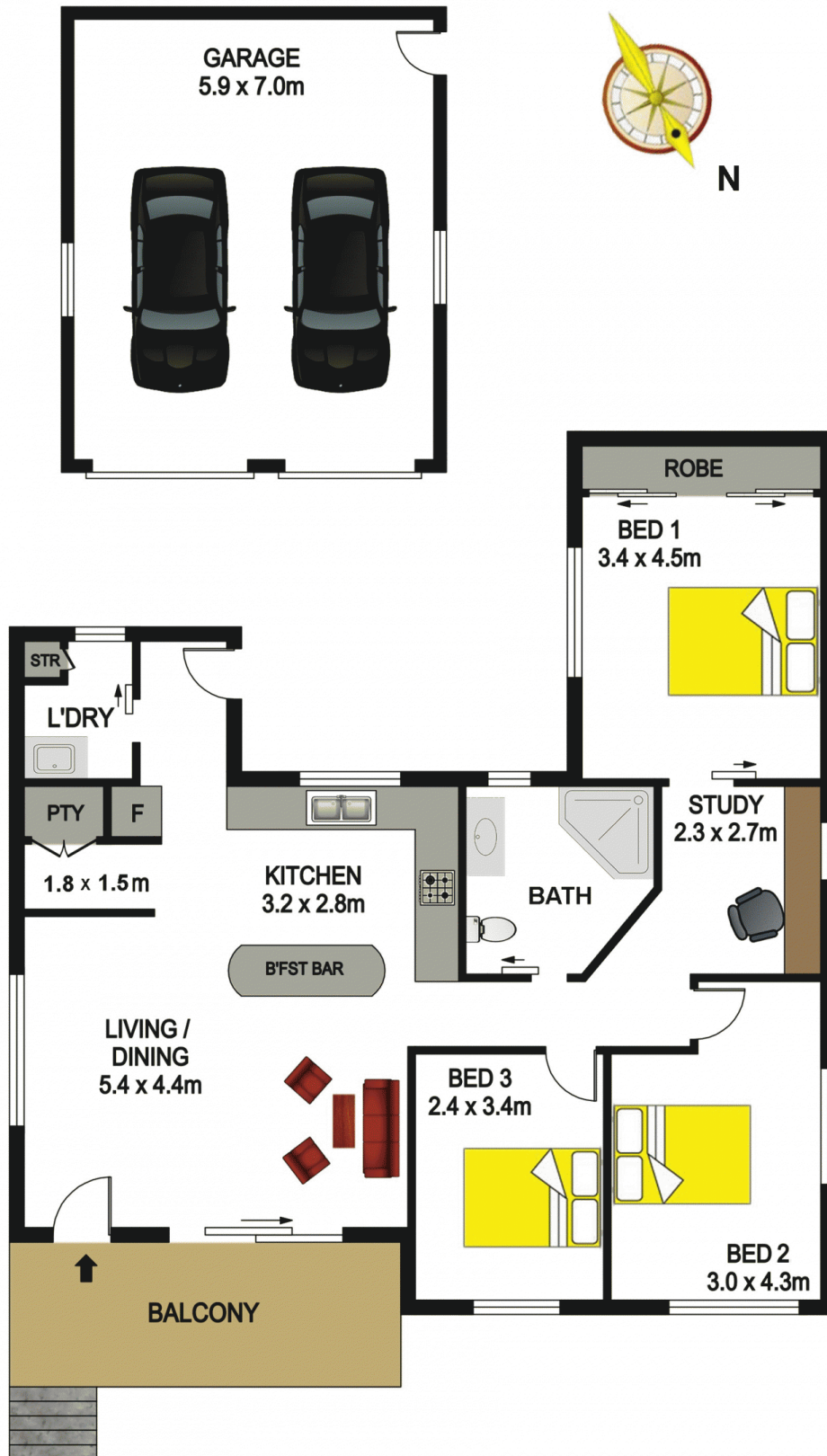

67 CASTLE STREET, CASTLE HILL

DISCLAIMER

PLANS SHOWN ARE FOR MARKETING PURPOSES ONLY, ALL DIMENSIONS ARE APPROXIMATE AND NOT TO SCALE. THEY ARE SUBJECT TO ERRORS AND INACCURACIES AND NO LIABILITY WILL BE ACCEPTED. INTERESTED PARTIES SHOULD MAKE THEIR OWN INQUIRES.