



11 Montrose Street QUAKERS HILL NSW

3 2 2

This dual level duplex is situated on a well maintained block, a short, 350m walk to Quakers Hill train station. The neat and tidy residence offers a functional floorplan with light filled interiors, and is ideal for families of all ages.

- Upon entering you are greeted with a sunny formal lounge and dining, a spacious family room adjoins the kitchen, and there is a powder room downstairs for guests. Heading upstairs there are three large bedrooms all with walk in robes, master with ensuite, and a moderate sized main bathroom.

- Extending out from the family room is a covered entertaining area, a perfect oasis to relax at the end of a busy day or enjoy entertaining family and friends.

- Additional features include a double lock up garage with internal access, two split system air conditioning units, internal laundry with access to the side paved area, and ample storage throughout. In close vicinity to Quakers Hill

View : <https://www.gilmour.com.au/sale/nsw/western-sydney/quakers-hill/residential/semi-detached/5620681>



Gilmour Property Agents
02 9899 3311



Ground Floor

DISCLAIMER:

Whilst every attempt has been made to ensure the accuracy of the floor plan contained here, no responsibility is taken for any error, omission, or miss-statement. This floor plan is intended as a guide only, for representation purposes only, and should be used as such by any prospective purchaser. No guarantee or warranties can be given, and any person using this information should rely on their own enquires.

Floor plan constructed by: jasonattardphotography.com.au

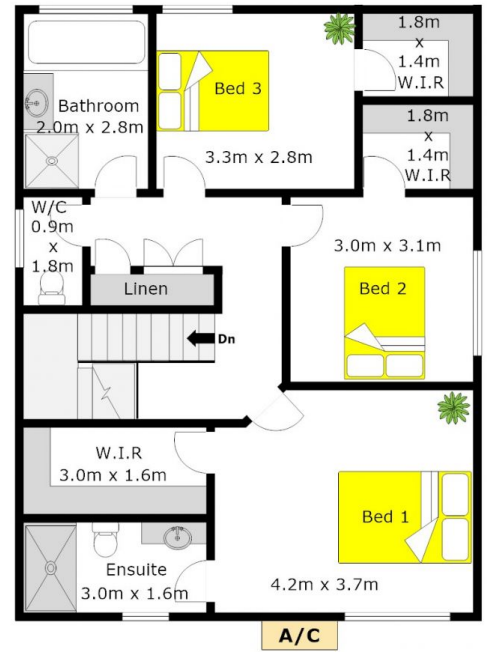

First Floor

