



## 10 Azalea Grove CASTLE HILL NSW

4 4 3

Situated in a whisper quiet, cul-de-sac position, is this beautiful family home. There is plenty of space for everyone with formal lounge and dining rooms, four modern bathrooms, as well as a large living area that opens to the entertaining spaces and pool.

- Four double size bedrooms; two of which have walk-in robes and ensuites, while the remaining two have built-in wardrobes.

- Any aspiring chef will be delighted with the contemporary Caesarstone kitchen featuring gas cooking, ample bench space and loads of storage.

- The separate rumpus room with cathedral ceilings and a slow combustion fire place is the perfect place to relax all year round.

- Bi-fold doors lead out to the alfresco entertaining area, also featuring cathedral ceilings, and the downlights make it great for night time entertaining.

**Land Size** : 733 sqm

**View** : <https://www.gilmour.com.au/sale/nsw/hills/castle-hill/residential/house/5620795>



**Gilmour Property Agents**  
**02 9899 3311**

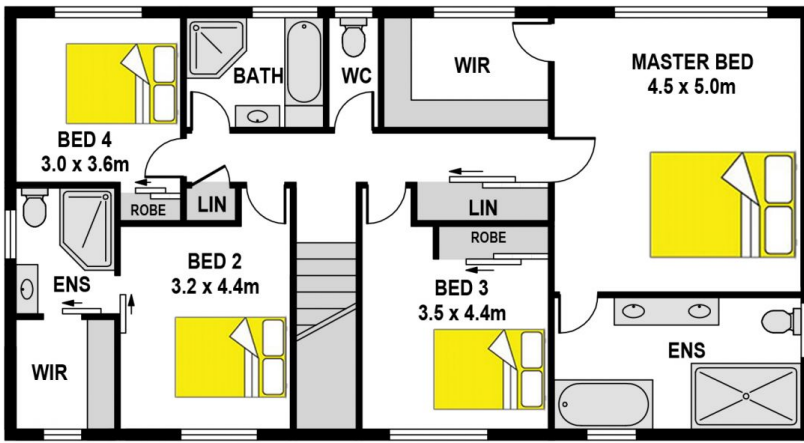

FIRST FLOOR



GROUND FLOOR



SITE PLAN



## 10 AZALEA GROVE, CASTLE HILL

**DISCLAIMER:**

All information contained herein is gathered from sources we consider to be reliable however we cannot guarantee or give any warranty to the information provided.